

# MODEL TS-01 TRANSDUCERS

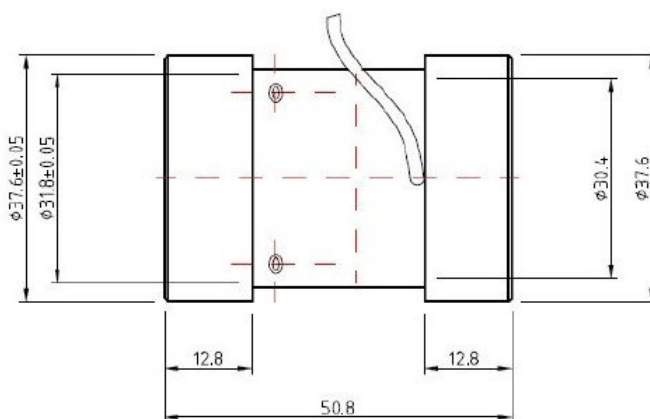
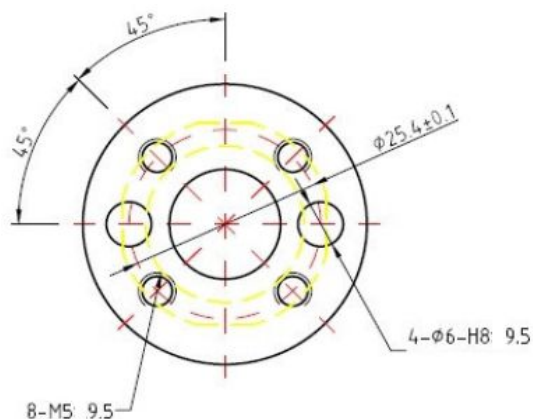

## Technical Data:

Capacity	1, 2, 3, 5, 6, 10, 20, 30, 50, 100, 150 NM	
Sensitivity	1.5 ~ 2.0mV/V	
Non-linearity	0.1% FS	
Repeatability	0.1% FS	
Hysteresis	0.1% FS	
Creep (30 min.)	0.1% FS	
Zero Balance	± 2% FS	
Insulation Resistance	≥ 5000 MΩ/100V DC	
Resistance	Input	410 ± 10Ω
	Output	350 ± 5Ω
Temperature Range	Compensated	-10 ~ 60°C
	Operating	-20 ~ 80°C
Temperature Effect	Output (span)	0.05% FS/10°C
	Zero	0.05% FS/10°C
Maximum Supply Voltage	15V	
Recommended Supply Voltage	5 ~ 10V	
Safe Overload	120%	
Maximum Overload	150%	
Construction	Alloy Steel / Stainless Steel	
Cable	4 Core Ø3 x 0.5m	

## Haris Sensor Technologies Private Limited

223, Shanti Industrial Estate, Sarojini Naidu Road, Mulund (West), Mumbai - 400080, INDIA.  
TeleFax: +91-22-2568 3435 / 2567 2204, 2205 ♦ E-mail: info@haris.in ♦ Website: www.harissensor.com

